

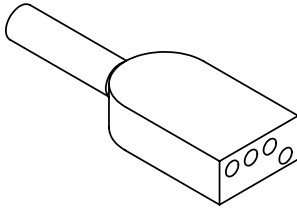

LP-IL4F

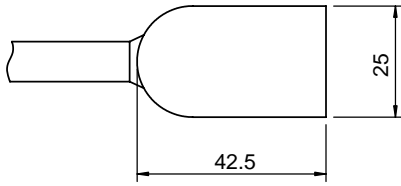

LP-IL4M

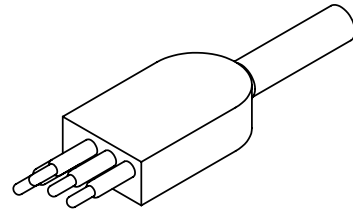
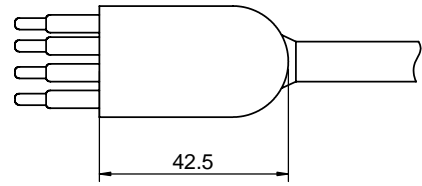

LP-BH4F

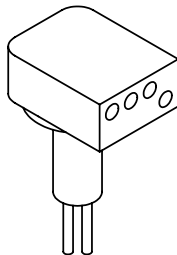
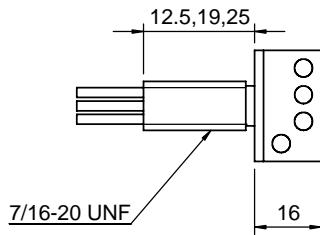

LP-BH4M

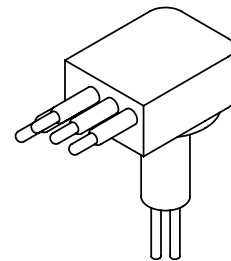
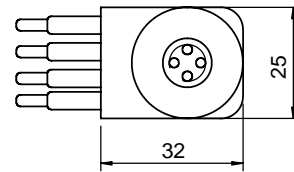

PIN LAYOUT

FEMALE

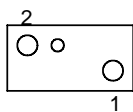

MALE

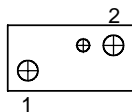

FEMALE

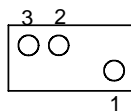

MALE

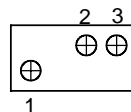

FEMALE

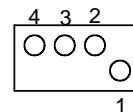

MALE

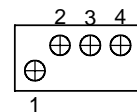



Low Profile (LP) Series 2-4 pins

Operation Specifications

Max Current	12A
Max Voltage	600V
Insulation	>250megaohm
Contacts	<0.01 ohm
Matings	>750
Temperature	-5C - +65C
Depth	>600 bar

Material Specifications

Molding	Low Carbon Neoprene
Bulkhead	Brass, 316 Stainless, Titanium
Contacts	Gold plated per MIL-G 45204 Type II, Grade D, Class 00
Pin	Phosphor Bronze
Sockets	Beryllium Copper
Location Pin	316 Stainless
O-ring	2-014 Nitrile
In-line cable	60cm, AWG 18 (0.82mm ²) 16/30 stranding
BH leads	30cm, AWG 18 Teflon, (0.97mm ²) 19/30 stranding

Cable Diameter and Current

Color Code

2 conductor OD 7.5mm	12A	1-Black, 2-White
3 conductor OD 8.1mm	12A	1-Black, 2-White, 3-Green
4 conductor OD 9.0mm	12A	1-Black, 2-White, 3-Red, 4-Green

